



Loktronic

SECURITY • TECHNOLOGY • RELIABILITY

FDH40S/R

surface & recess mounting

fire door holding electromagnets

12 & 24 VDC selectable



Option A – Surface Mounted
Wall to door distance: 73mm

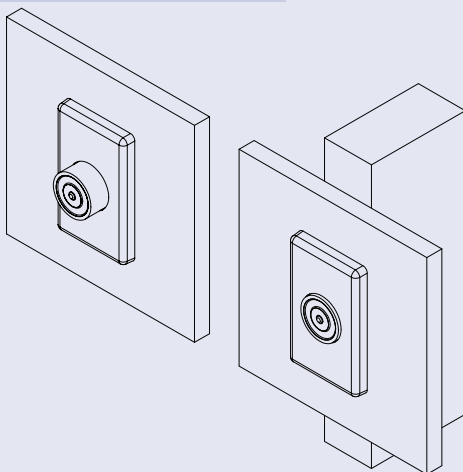

Option B – Recess Mounted
Minimum wall to door distance: 57mm



Satin Aluminium Gloss Black Gloss White

- 10 year guarantee*
- Satin aluminium, gloss black or gloss white covers
- One model covers both surface mount and recess mount options
- For surface mount use nylon base intact with choice of cover
- For recess mount, separate inner and outer mounting plates and mount inner plate to a stud or similar. Mount outer plate to wall.
- Low power consumption for lower operating temperature
- Universal armature - offsets to 55° to suit doors opening past 90°
- Additional flexible mounting in both planes to speed alignment
- 12 & 24 VDC are selectable at the PCB
- Push off button means no residual magnetism
- Oversize armature for easy alignment
- All stainless steel fittings
- Electroless nickel plated armature and electromagnet for maximum durability and aesthetic appeal
- Designed, tested and produced in New Zealand to AS 4178
- Full local support and back up

Loktronic

Loktronic Limited Unit 7 19 Edwin Street Mt Eden Auckland
P O Box 8329 Symonds Street Auckland 1150 New Zealand
Ph 64 9 623 3919 Fax 64 9 623 3881 0800 FOR LOK
mail@loktronic.co.nz www.loktronic.co.nz



*Standard terms and conditions of sale apply

For full specifications please consult the Product Specification Document (PSD)